

(BELCO)		GEOLOGIC PROGNOSIS			DISTRIBUTION	
LOBITOS OFFSHORE AREA		Z2A-21-584-CD-L06 OFFICIAL WELL NUMBER		L06-17 BELCONº	TYPE OF WELL CONFIRMATORY	RIG Nº III
OBJECTIVE		PRIMARY: Rio Bravo Sandy SECONDARY: -----				
SURFACE COORDINATES				TARGET COORDINATES		
N 9'509,029.49 1'598,634.59 m, E 459,305.80 124,656.60 m				N 9'509,100 1'598,700 m, E 458,740 124,090 m		
ELEVATIONS	K. B. 50 FT.		DIRECTION OF DEVIATED WELL N 83 ° W		DRILLED DEPTH TO TARGET 3950 FT.	
	<input checked="" type="checkbox"/> WATER DEPTH 335		(INITIAL) CONDUCTOR ANGLE FROM VERTICAL Vert. °		TRUE VERTICAL DEPTH TO TARGET 3250 FT.	
	<input type="checkbox"/> GROUND LEVEL -- FT.		RECOMMENDED DEPTH OF K.O.P. 600 FT.		EST. DEVIATION (MAX. ANGLE) 42 °	
ESTIMATED FINAL DRILLED DEPTH 6860 FT.			BUILD UP ANGLE AT. 4 ° PER 100 FT.		HORIZONTAL DRIFT TO TARGET 1870 FT.	
EST. DRILLING TIME TO T.D. 26 DAYS					HORIZONTAL DRIFT TO TOTAL DEPTH 3820 FT.	
EXPECTED STRATIGRAPHIC SEQUENCE	FORMATION / MEMBER		DRILLED TOP	SUBSEA TOP	OBSERVATIONS / POSSIBLE PROBLEMS	
	Talara		At Surface			
	Chacra		3000	2500		
	Rio Bravo Sdy.		3950	3200	Pay Zone	
	Rio Bravo Shaly		6650	5250		
	T.D.		6850	5380		
CONTROL	TARGET LIMITS	TOP	LEFT 300	RIGHT 300	OBSERVATIONS	
		BASE	400	400		
	BIT SAMPLES TO BE TAKEN:	EVERY 30 FT.FROM SURF TO 2500 AND EVERY 10 FT.FROM 2500 TO TOTAL DEPTH				
LOGGING	RECOMMEND.FOR PALEO-PALYNOLOGY Throughout the well					
	RECOMMENDED OPEN HOLE DLL-MSFL-GR; FDC-CNL-GR					
	RECOMMENDED AFTER CASING GR-CCL					
EVALUATION	NEARBY WELLS FOR CORRELATION L06-16, L06-21, L06-13X					
	SIDEWALL CORES Not considered					
	CONVENTIONAL OR ♦ CORES None					
	GAS LOGGER None					
FORMATION TESTING None						
PREPARED BY: <i>Mario Chavez C.</i>			LIMA PERU		APPROVED <i>[Signature]</i>	
October 1st, 1984 DATE					6 Oct 3/84 DATE	

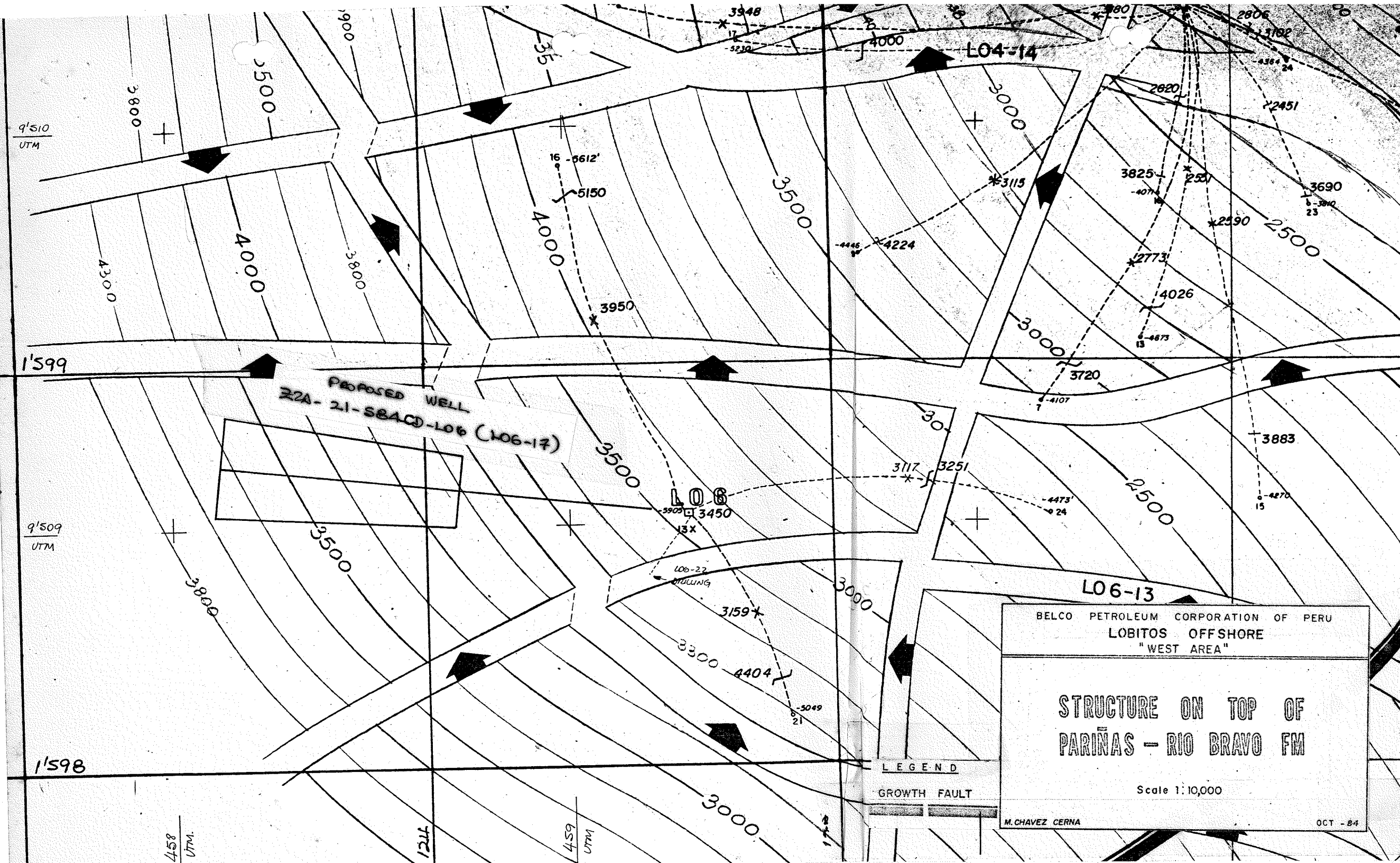

9°510'
UTM

9°509'
UTM

1°598'

458
UTM

124

459
UTM

LEGEND

GROWTH FAULT

BELCO PETROLEUM CORPORATION OF PERU
LOBITOS OFFSHORE
"WEST AREA"

STRUCTURE ON TOP OF
PARÍÑAS - RIO BRAVO FM

Scale 1:10,000

M. CHAVEZ CERNA

OCT - 84

EAST

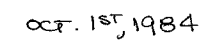

BELCO PETROLEUM CORPORATION OF PERU

MEMORANDUM

A: Geology Manager

Fecha October 3rd, 1984

DE: Chief Reservoir Engineer

Asunto WELL L06-17

Reservoir concurs with the location proposed for next well from L06 platform. It is in fact a moderate long kick out to the west in an undrilled quadrant, a double spacing offset of the well presently drilling.

Because of the semi-exploratory character of this well a complete suit of logs is included as per the guidelines. Target size is also in accordance with the guidelines.

Jesús Castillo S.
Chief Reservoir Engineer

JCS/rmr.

BELCO PETROLEUM CORPORATION OF PERU

MEMORANDUM

A: Geology Manager

Fecha October 1st, 1984

DE: Mario Chávez

Asunto GEOLOGICAL COMMENTS FOR L06-17 WELL

Location is in the western quadrant of the L06 platform.

Purpose of this location is to confirm the extension towards west of the Rio Bravo sands drilled in wells L06-16 and L06-21. The information gathered from this well will be important for the development of this platform and for the generation of new prospects south and north of the L06.

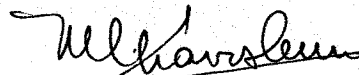

Mario Chávez C.
Area Geologist

MCHC/ghp.