

BELCO		GEOLOGIC PROGNOSIS			DISTRIBUTION	
Lobitos Offshore		Z2 A-21-599-D-L06		L06-7	TYPE OF WELL	
AREA		OFFICIAL WELL NUMBER		Development		RIG No III
OBJECTIVE		PRIMARY: Rio Bravo Sds. SECONDARY: -----				
SURFACE COORDINATES				TARGET COORDINATES		
N 9'509,032.90 1'598,638.00				m, E 459,306.04 124,656.84 m		
N 9'508,490 1'598,075				m, E 459,230 124,600 m		
ELEVATIONS	K.B. 50 FT.		DIRECTION OF DEVIATED WELL S 09 ° W		DRILLED DEPTH TO TARGET 3300 FT.	
	<input checked="" type="checkbox"/> WATER DEPTH 335' FT.		(INITIAL) CONDUCTOR ANGLE FROM VERTICAL 15 °		TRUE VERTICAL DEPTH TO TARGET 2650 FT.	
	<input type="checkbox"/> GROUND LEVEL - FT.		RECOMMENDED DEPTH OF K.O.P. 800 FT.		EST. DEVIATION (MAX. ANGLE) 45 °	
ESTIMATED FINAL DRILLED DEPTH 6150 FT.			BUILD UP ANGLE AT. 4 ° PER 100 FT.		HORIZONTAL DRIFT TO TARGET 1800 FT.	
EST. DRILLING TIME TO T.D. 22 DAYS					HORIZONTAL DRIFT TO TOTAL DEPTH 3800 FT.	
EXPECTED STRATIGRAPHIC SEQUENCE	FORMATION / MEMBER		DRILLED TOP	SUBSEA TOP	OBSERVATIONS / POSSIBLE PROBLEMS	
	Talara		At Surface			
	Chacra		2700	2150		
	Rio Bravo Sdy.		3300	2600		
	-Mid Mass. Sds.		4250	3300	Pay Zone	
	Rio Bravo Shly.		5950	4500		
	TD		6150	4650		
CONTROL	TARGET LIMITS	TOP	LEFT 150	RIGHT 100	OBSERVATIONS	
		BASE	300	200		
	BIT SAMPLES TO BE TAKEN:	EVERY 30 FT. FROM SURF TO 2000 AND EVERY 10 FT. FROM 2000 TO TOTAL DEPTH				
LOGGING	RECOMMEND. FOR PALEO-PALYNOLOGY		From 2000			
	RECOMMENDED OPEN HOLE		IEL-GR			
	RECOMMENDED AFTER CASING		GR-CCL			
	NEARBY WELLS FOR CORRELATION		L06-22, L06-21, L06-13X			
EVALUATION	SIDEWALL CORES		Not considered			
	CONVENTIONAL OR ♦ CORES		None			
	GAS LOGGER		None			
	FORMATION TESTING		None			
PREPARED BY: Mario Chávez C. MARIO CHAVEZ CERNA INGENIERO GEOLOGO November 29, 1984 DATE PERU						APPROVED MARCO ANTONIO CHAVEZ LURQUIN INGENIERO GEOLOGO Nov. 30/84 DATE

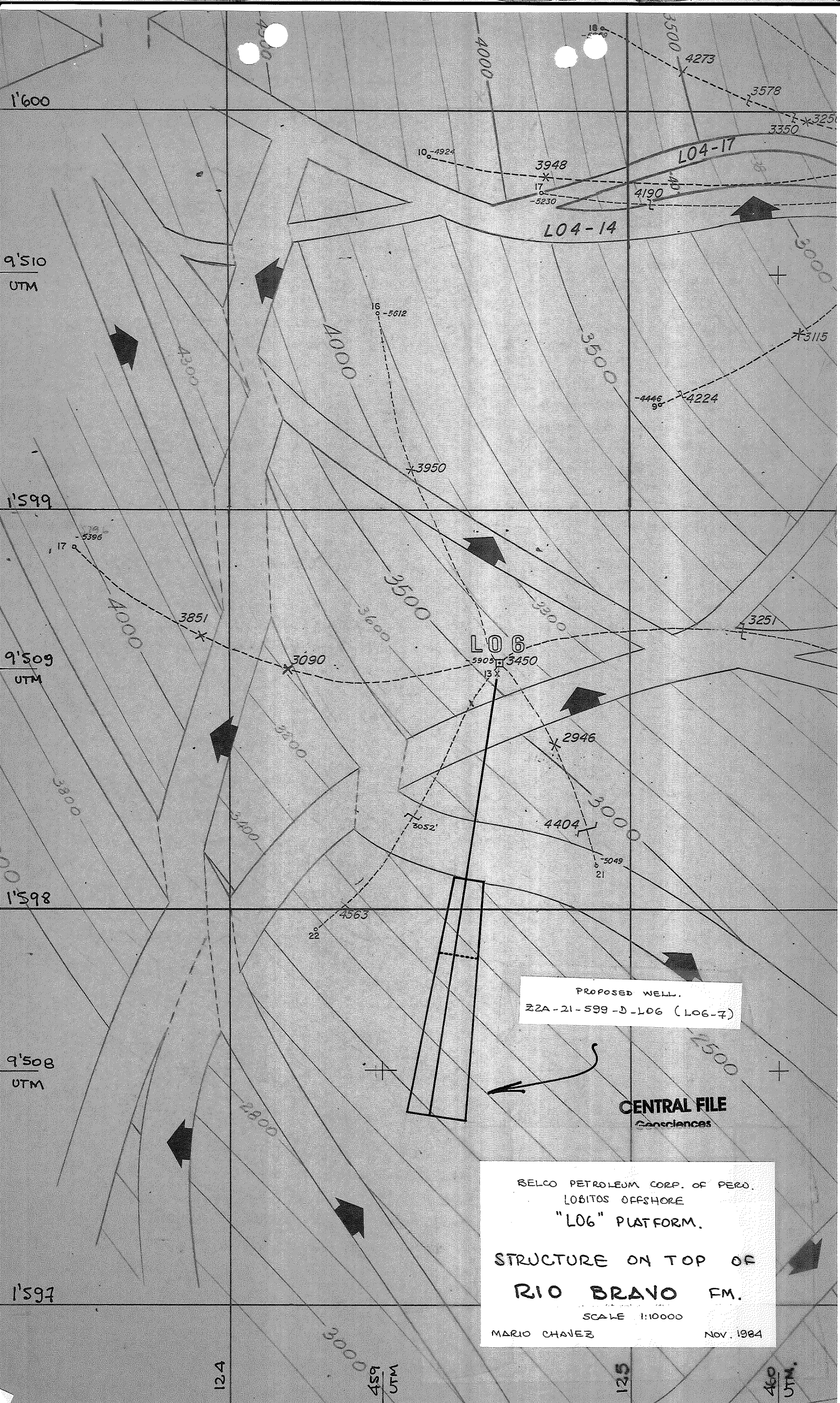

SSW

S 09° W

SEA LEVEL

LOG

NNW

BELCO PETROLEUM CORP. OF PERU
LOBITOS OFFSHORESSW-NNW STRUCTURAL CROSS SECTION
FOR PROPOSED WELL
Z2A-21-599-D-LOG (LOG-7)

SCALE 1:10,000

MARIO CHAVEZ

NOV. 1984.

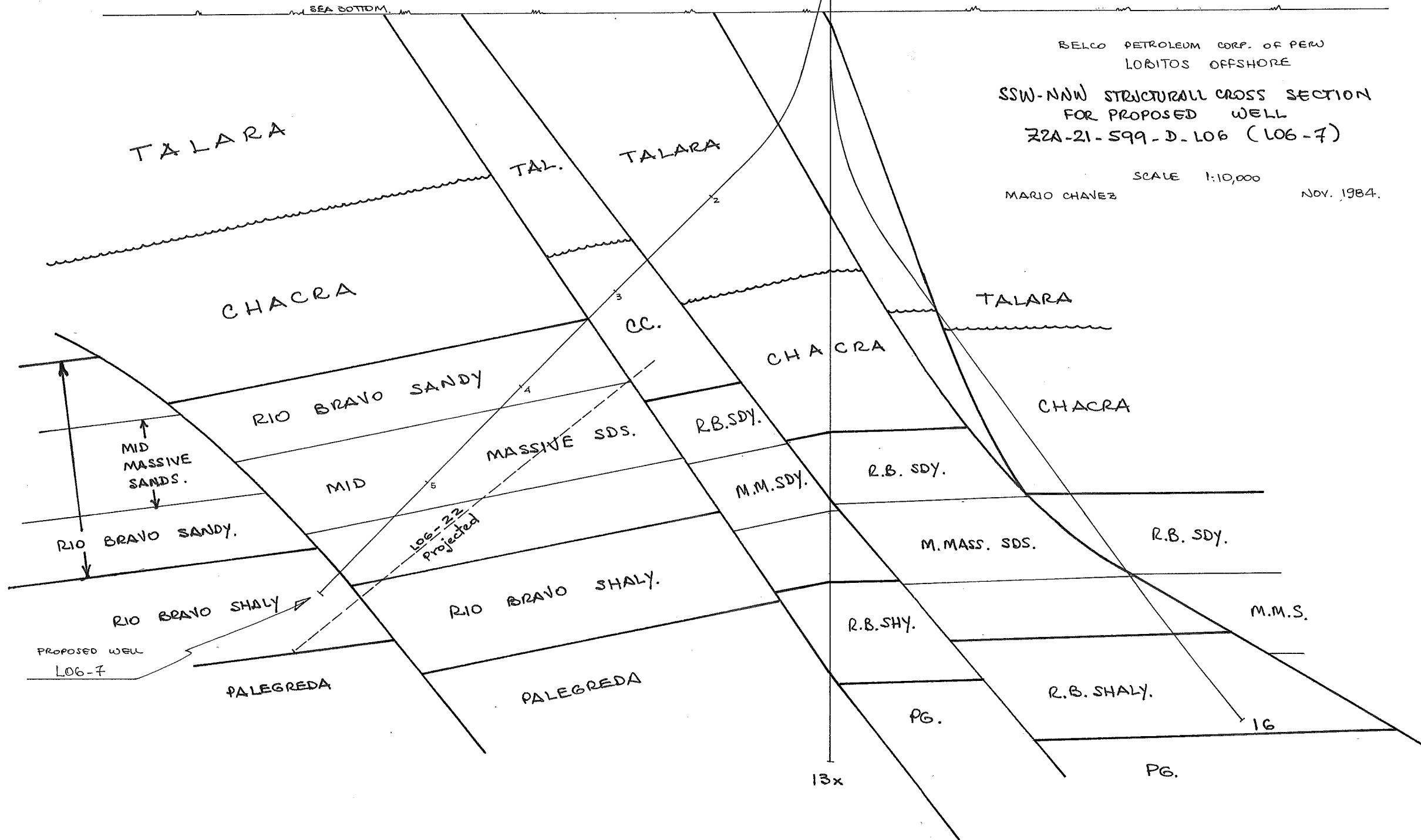

BELCO PETROLEUM CORPORATION OF PERU

M E M O R A N D U M

A: GEOLOGY MANAGER Fecha November 30th, 1984
DE: CHIEF RESERVOIR ENGINEER Asunto WELL L06-7

Following is the short term drilling strategy discussed and agreed with FVM, the next well of L06 is a normal spacing (30 acres at main productive sand level), well from L06-22, is one of the good producers at L06 thus far.

Logging program is limited to the IES log and target size is corresponding to the type of well proposed.

Reservoir concurs with the proposed location.

Jesús Castillo S.
Chief Reservoir Engineer

JCS/rmr.

BELCO PETROLEUM CORPORATION OF PERU

MEMORANDUM

A: Geology Manager Fecha November 29th, 1984
DE: Mario Chávez Asunto Well L06-7

Well L06-7 is an offset towards south-east of well L06-22 which had a complete section of the Rio Bravo sdy Mid-Massive "Marmaja" sands.

Proposed well is located in a large block of approx. 340 acres.

Quality of sands is expected to be similar to that encountered in well L06-22.

As of October 1984, well L06-22 had accumulated 6,649 BO in 12 days, flowing. The IPR was 624 BOPD, and last test indicate well was producing at a rate of 554 BOPD. This well should be a confirmatory for proposed platform SE-L06.

Logging program includes IEL-GR only.

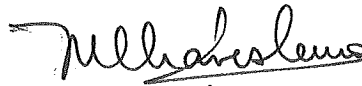
Mario Chávez
Area Geologist

MCH/ghp.