

<div><div>BELCO</div><div>GEOLOGIC PROGNOSIS</div></div>		DISTRIBUTION					
Lobitos Offshore AREA		Z2 A-21-618-D-L06 OFFICIAL WELL NUMBER	L06-8 BELCONº	TYPE OF WELL	Development	RIG Nº III	
OBJECTIVE		PRIMARY: Rio Bravo Sdy M. Mass. Sds.)		SECONDARY: -----			
SURFACE COORDINATES				TARGET COORDINATES			
N 9°509,033.10 1°598,638.20		m, E 459,309.69 124,660.49		N 9°508,465 1°598,050		m, E 458,980 124,350	
ELEVATIONS	K. B. 50 FT.		DIRECTION OF DEVIATED WELL S 30 ° W		DRILLED DEPTH TO TARGET 3700 FT.		
	<input checked="" type="checkbox"/> WATER DEPTH		(INITIAL) CONDUCTOR ANGLE FROM VERTICAL 15 °		TRUE VERTICAL DEPTH TO TARGET 2850 FT.		
	<input type="checkbox"/> GROUND LEVEL 335' FT.		RECOMMENDED DEPTH OF K.O.P. 600 FT.		EST. DEVIATION (MAX. ANGLE) 46 °		
ESTIMATED FINAL DRILLED DEPTH 7000 FT.		BUILD UP ANGLE AT 4 ° PER 100 FT.		HORIZONTAL DRIFT TO TARGET 2150 FT.			
EST. DRILLING TIME TO T.D. 23 DAYS					HORIZONTAL DRIFT TO TOTAL DEPTH 4550 FT.		
EXPECTED STRATIGRAPHIC SEQUENCE	FORMATION / MEMBER		DRILLED TOP	SUBSEA TOP	OBSERVATIONS / POSSIBLE PROBLEMS		
	Talara		At Surface				
	Chacra		3200	2450	Faulted top		
	Rio Bravo Sdy.		3700	2800			
	Mid. Mass. Sds.		4650	3450	Pay zone		
	Rio Bravo Shly.		6800	4950			
	TD.		7000	5100			
CONTROL	TARGET LIMITS	TOP BASE	LEFT 150 300	RIGHT 150 300	OBSERVATIONS		
	BIT SAMPLES TO BE TAKEN:	EVERY 30	FT.FROM SURF TO 3000 AND				
		EVERY 10	FT.FROM 3000 TO TOTAL DEPTH				
RECOMMEND.FOR PALEO-PALYNOLOGY		From 3000					
LOGGING	RECOMMENDED OPEN HOLE		IEL-GR				
	RECOMMENDED AFTER CASING		GR-CCL				
	NEARBY WELLS FOR CORRELATION		L06-22, L06-7				
EVALUATION	SIDEWALL CORES		Not considered				
	CONVENTIONAL OR ♦ CORES		None				
	GAS LOGGER		None				
	FORMATION TESTING		None				
PREPARED BY: Mario Chávez		APPROVED					
April 3rd, 1985		DATE		LIMA PERU			
				April 3/85			
				DATE			

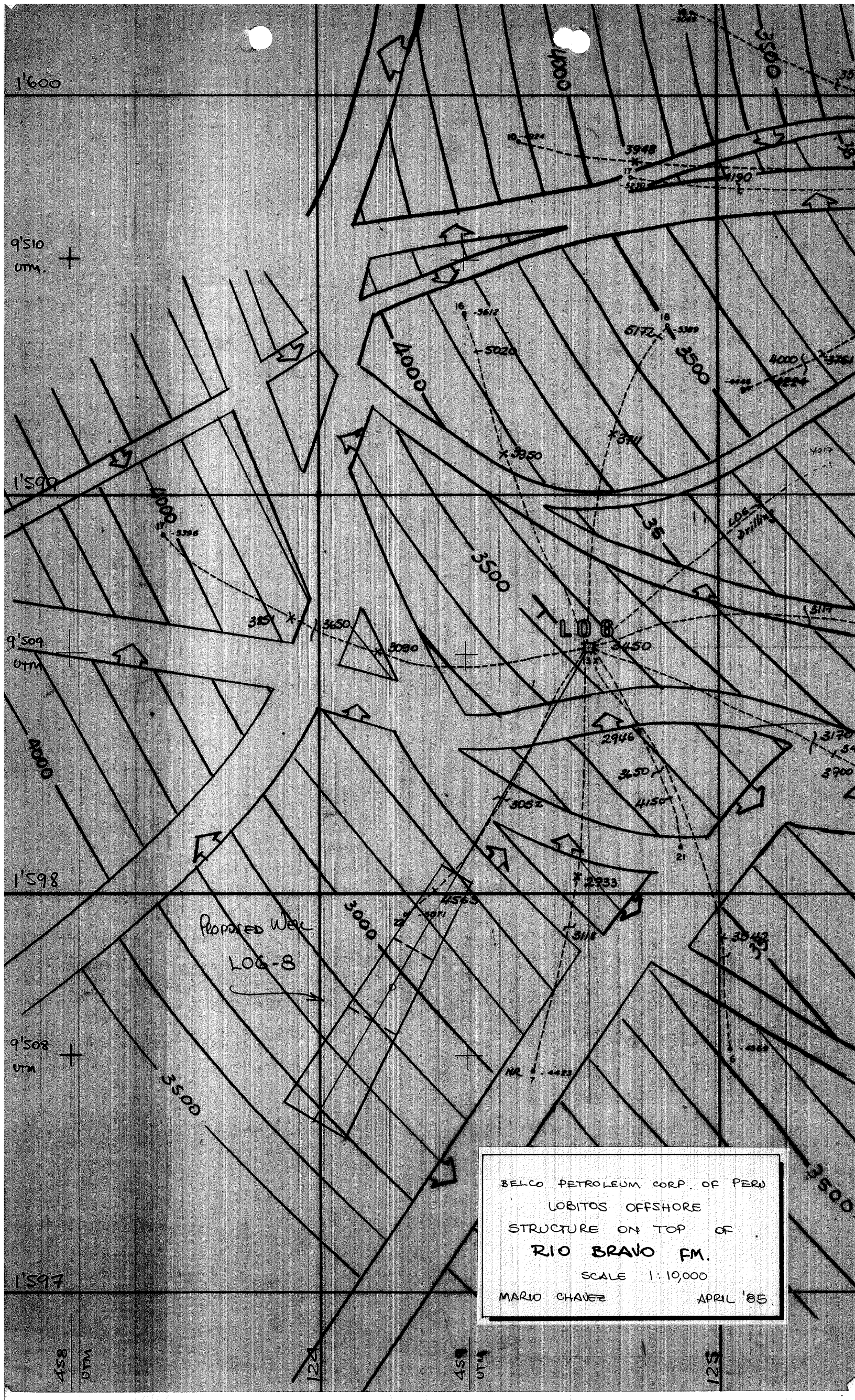

BELCO PETROLEUM CORP. OF PERU
LOBITOS OFFSHORE
STRUCTURE ON TOP OF
RIO BRAVO FM.
SCALE 1:10,000
MARIO CHAVEZ APRIL '85

SW

LOG

NE

BELCO PETROLEUM CORP. OF PERU.

LOBITOS OFFSHORE

SW-NE STRUCTURAL CROSS SECTION
FOR PROPOSED WELL:

Z2A-21-618-D-LOG (LOG-8)

SCALE 1:10,000

MARIO CHAVEZ

APRIL 1985

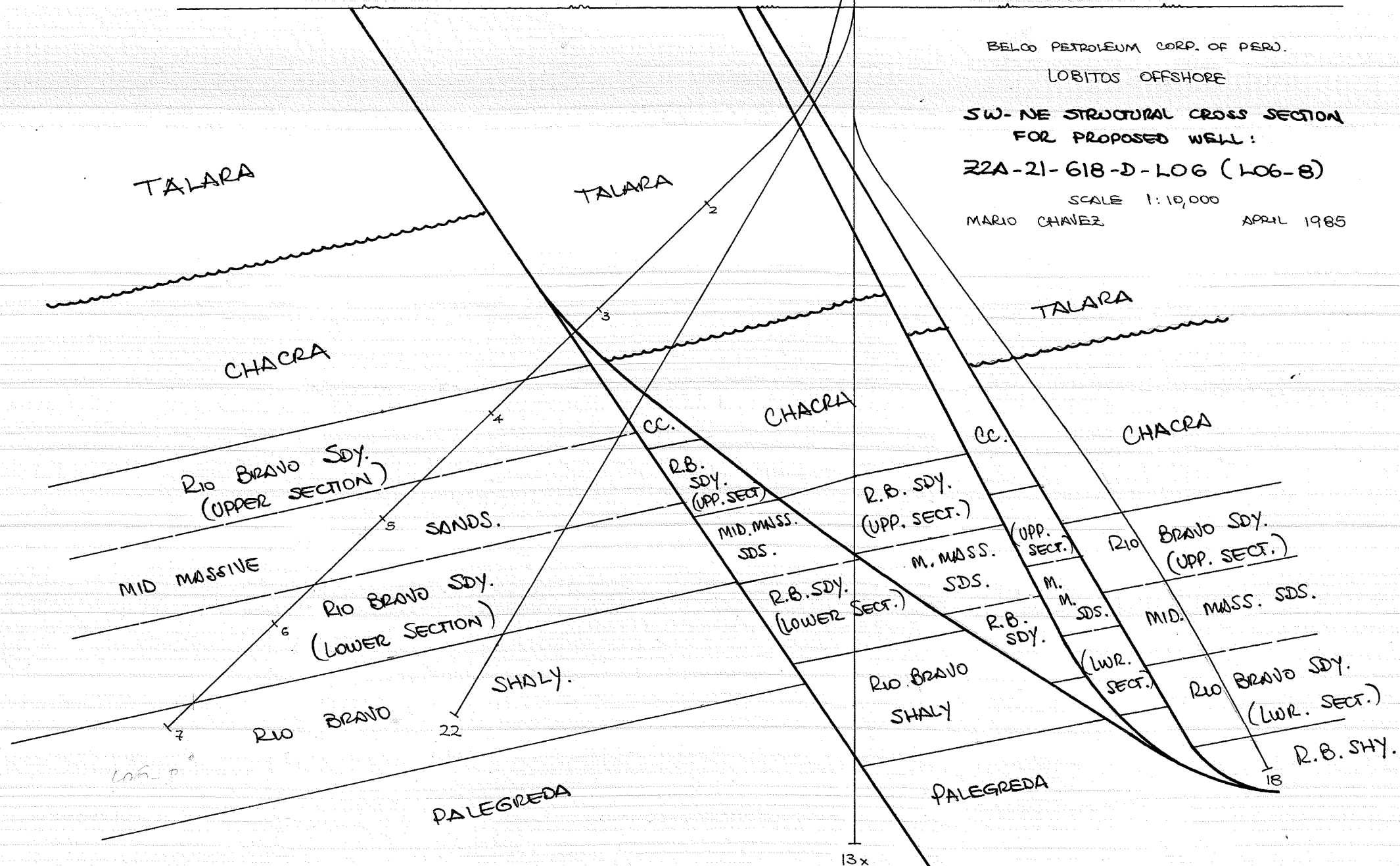

BELCO PETROLEUM CORPORATION OF PERU
M E M O R A N D U M

A: Geology Manager

Fecha April 3rd, 1985

DE: Mario Chávez

Asunto Geological Comments for Well
L06-8.-

Reference well is overtracking well L06-22 which have accumulated 58,357 BO in 132 days. Presently is flowing at a rate of 406 BOPD.

Present well is located in a block of more than 250 acres. Compensatory fault(s) to the dip, towards northeast are expected in this area. Success of this well should enhance the merits of proposed platform "SE of L06" in about 300 ft. W.D.

Logging program includes IEL-GR only.

Mario Chávez
Area Geologist

MCH/ghp.

BELCO PETROLEUM CORPORATION OF PERU
M E M O R A N D U M

A: GEOLOGY MANAGER

Fecha April 3rd, 1985

DE: CHIEF RESERVOIR ENGINEER

Asunto WELL L06-8

Subject well is a long kick out offsetting well L06-22 with adequate spacing at the expected position of the main sands.

Reservoir concurs with the location as well as with the logging program and target size specified.

Jesús Castillo S.
Chief Reservoir Engineer

JCS/rmr.